



CONTACT
INDUSTRIES INC



HEAVY-DUTY CONTACTORS

70AMP – 2000AMP

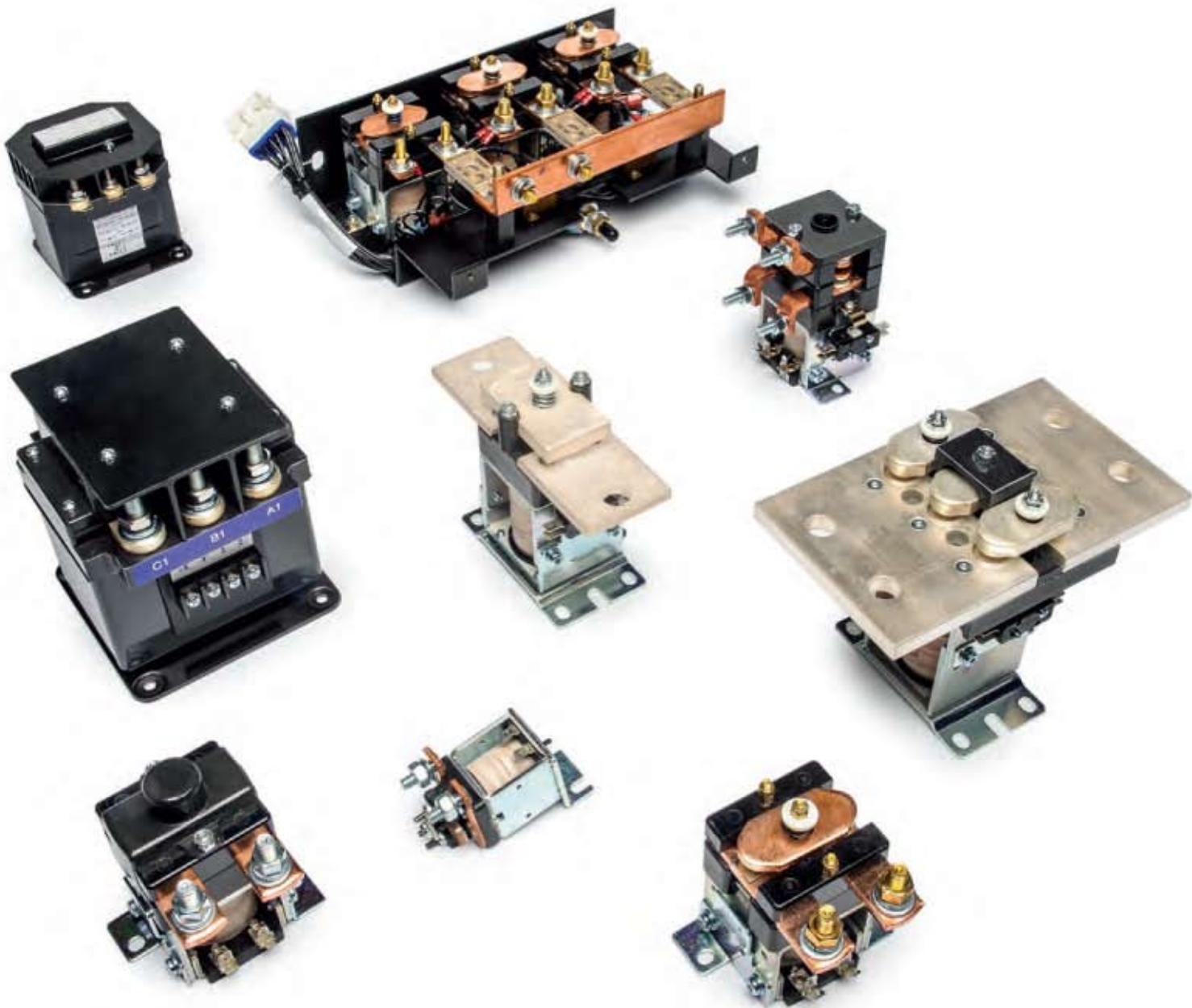

Contact Industries Inc. offers a complete line of DC contactors to meet a wide range of DC current requirements, switching configurations and operating conditions – including low voltage disconnects, DC motor reversers and ordinary on-off switches. Our three phase AC series is rated from 100 to 400 amperes.

Over a million of our open frame contactors are in service today in the **telecommunications, computer, electric vehicle and industrial lift truck industries.** Our enclosed contactors are widely used in military and commercial ground power systems.

Contact Industries Inc. works closely with customers to meet their specific electrical requirements. Our wide range of existing designs, along with our ability to adjust mechanical designs to fit custom mounting configurations, give us the flexibility to provide the **optimum solution for virtually any application.**

You can expect fast response on quotations, samples and final assembly drawings. Our manufacturing lead times remain the best in the industry for both standard and custom contactor designs.



APPLICATIONS

- Telecom Power Systems
- Industrial Forklift Trucks
- Material Handling Equipment
- Military Power Generation
- Aviation Ground Support
- Welding
- UPS Systems
- Electric Vehicle
- Battery Chargers
- Industrial Test Equipment
- Public/ Commercial Safety Systems

FEATURES

- High reliability and quality – Tested in excess of 1,000,000 mechanical operations
- Rugged construction – Manufactured with heavy duty, high temperature, state-of-the-art materials
- Compact size – Ideally suited for small space requirements in DC power equipment
- Improved serviceability – Fewer fasteners and a more efficient design reduces time for component servicing or replacement
- Flexible mounting and installation – The unique mounting bracket system is designed to fit many standard and custom hole patterns
- Highly efficient magnetic circuit – Produces consistent operation in a smaller size
- High temperature coil construction – Capable of operating at 155°C and a flame retardant rating of UL-94VO
- Large cross section bus bars – Provides cooler operation at higher current levels
- High temperature insulating materials – Our glass-filled thermoset materials are capable of operating in excess of 180°C
- Silver alloy tips – New manufacturing technology produces high quality tips for extended life
- Double break contacts – allow operating voltages of 6-72 VDC



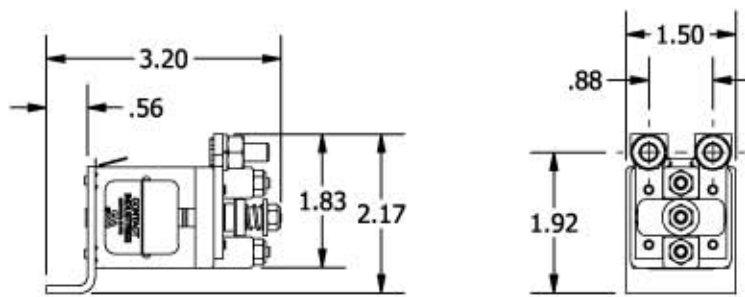

Continuous Rating
 SPST - N.O.
 SPST - N.C.

Options
 Aux. Switch
 UL Listed
 Metric Hardware
 Magnetic Latching

CT 70 Series - 70 AMP

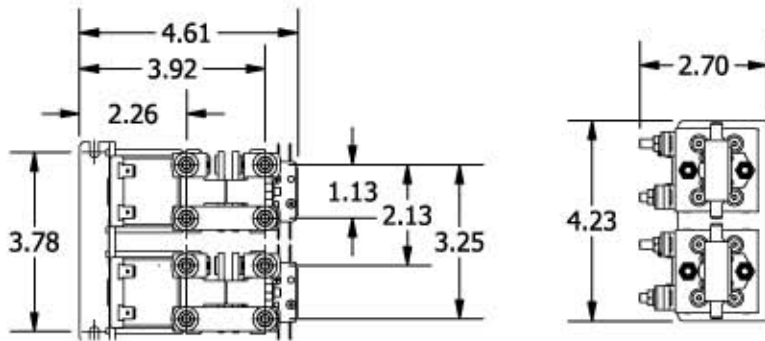

Continuous Rating
 SPST - N.O.
 SPST - N.C.
 SPDT
 FOR/REV

Options
 Aux. Switch
 UL Listed
 Metric Hardware

CT 125 Series - 125 AMP

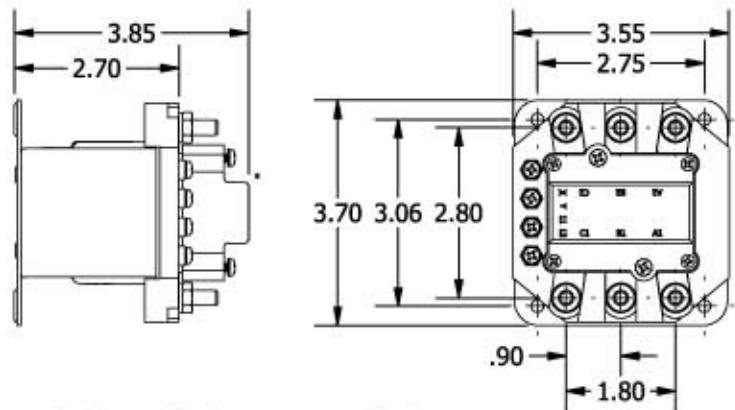

Continuous Rating
 3PST

Options
 Aux. Switch
 UL Listed

CT 150 Series - 150 AMP

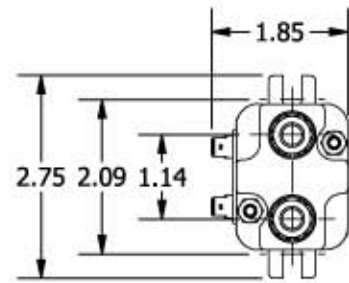
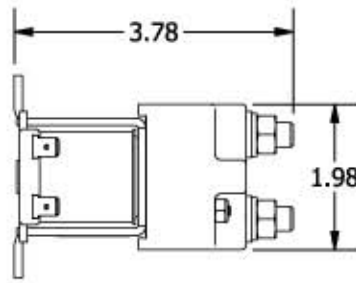

Continuous Rating
SPST - N.O.

Options
Aux. Switch
UL Listed
Metric Hardware

CT 156 Series - 150 AMP

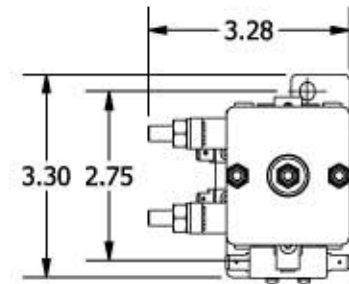
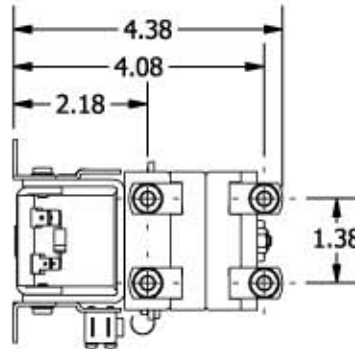

Continuous Rating
SPST - N.O.
SPST - N.C.
SPDT

Options
Aux. Switch
UL Listed
Metric Hardware
Magnetic Latching

CT 200 Series - 200 AMP

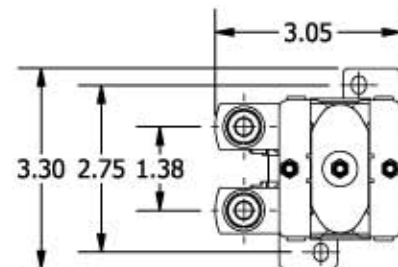
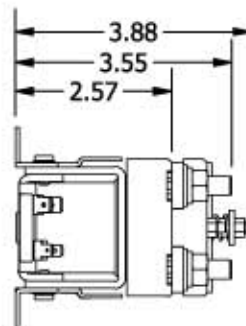

Continuous Rating
SPST - N.O.

Options
Aux. Switch
UL Listed
Silver Plated Bus Bars
Metric Hardware
Magnetic Latching

CT 300 Series - 300 AMP

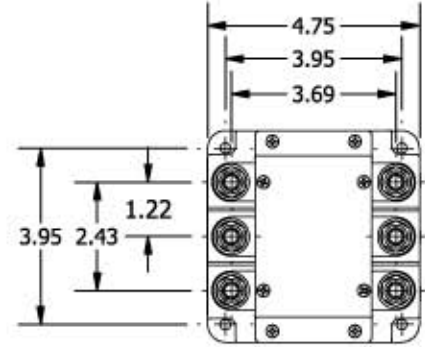
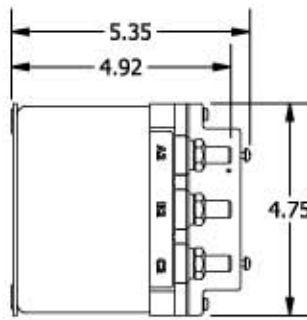

Continuous Rating
3PST - N.O.

Options
Aux. Switch
UL Listed
Silver Plated Bus Bars
Metric Hardware

CT 350 Series - 350 AMP

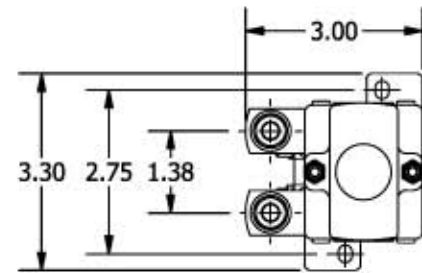
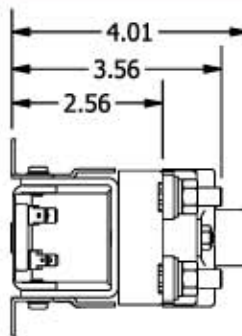

Continuous Rating
SPST - N.O.

Options
Aux. Switch
UL Listed
Silver Plated Bus Bars
Metric Hardware
Magnetic Latching

CT 400 Series - 400 AMP

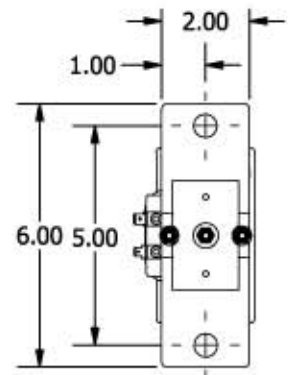
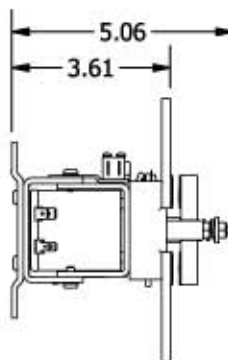
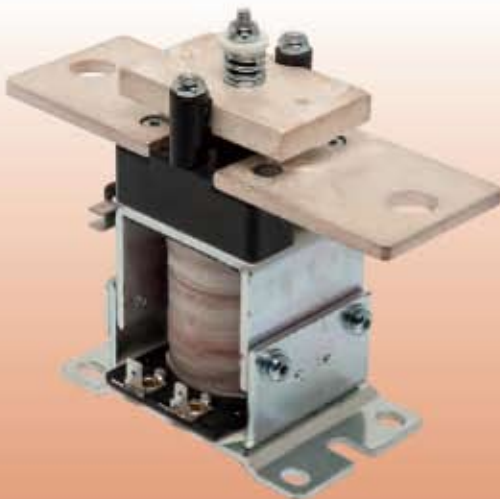

Continuous Rating
SPST - N.O.

Options
Aux. Switch
UL Listed
Silver Plated Bus Bars
Metric Hardware
Magnetic Latching

CT 600A Series - 600 AMP

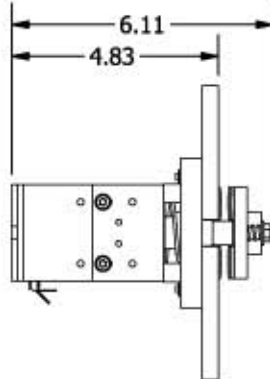
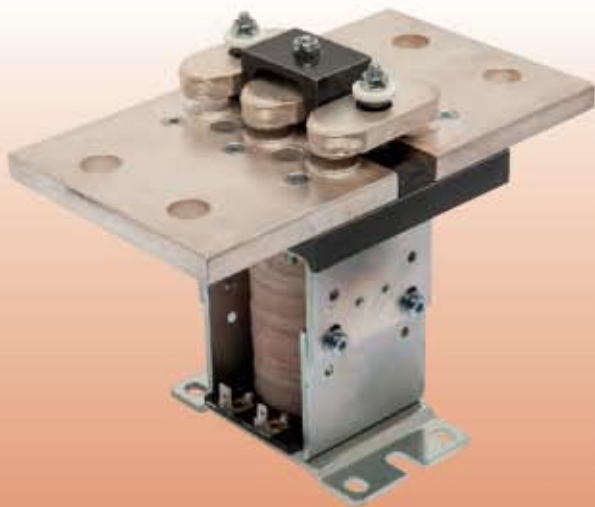

Continuous Rating
SPST - N.O.

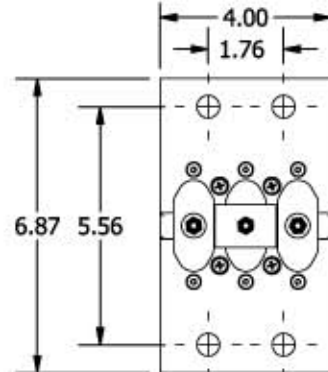

Options
Aux. Switch
UL Listed
Silver Plated Bus Bars
Magnetic Latching

CT 2000 Series - 2000 AMP

ADDITIONAL PRODUCTS



Forklift Control Panel



Service Kits

COIL SPECIFICATIONS

Regular

- DC Coil Voltages: 12, 24, 27, 36, 48, 54, 60, 72, 120
- Intermittent and Continuous Duty
- Quick Disconnects

Options

- Built-in Rectification
- Suppression
- Other Voltages up to 120 VDC

OTHER OPTIONS

Magnetic blowout on 100, 200, 300 and 400 AMP units for operating voltages between 72 and 150 VDC.

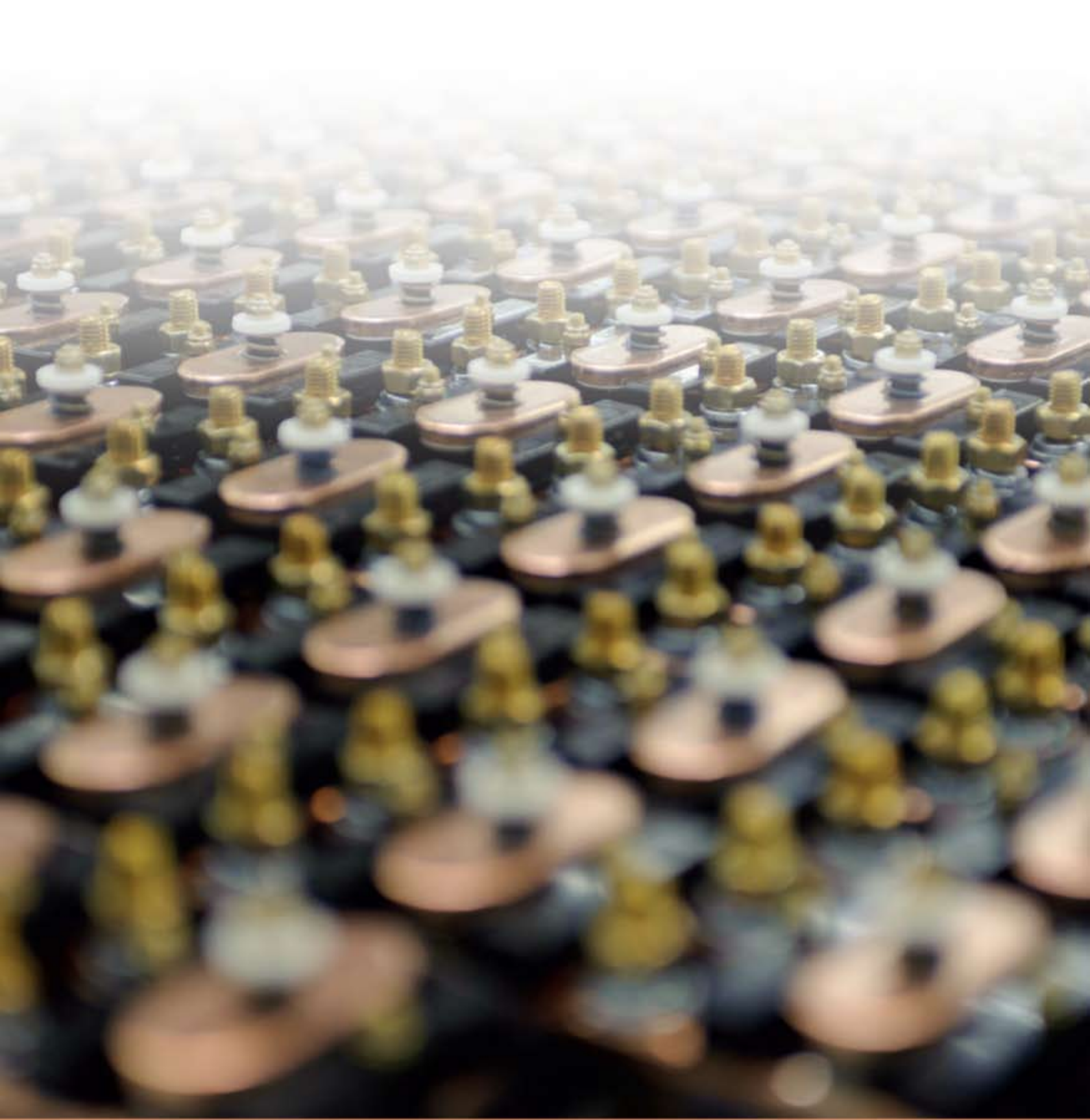

25 Lex-Industrial Dr.
P.O. Box 3086
Lexington, OH 44904
Phone: 419-884-9788
Fax: 419-884-9767
www.contactindustriesinc.com